



Jan.2016 edition

International market products	Rated speed (m/s)	Rated capacity (kg)	The product described in this brochure
MS(CHOI-II J) Small machineroom Machine roomless passenger elevator	1.0 1.6 1.75 2.0 2.5	400 450 630 800 900 1000 1150	●
MS(CHOI-II J) Small machineroom Machine roomless passenger elevator	1.0 1.6 1.75 2.0 2.5	800 900 1000 1150 1275 1350 1600	
MS(CHOI-II) Small machineroom passenger elevator	1.0 1.6 1.75 2.0 2.5	630 800 900 1000 1150	
NS (CHOI-MRL) Machine roomless passenger elevator	1.0 1.6 1.75 2.0	630 800 1000	
NS (RICH-MRL) Machine roomless high-end business passenger elevator	1.0 1.6 1.75 2.0	630 800 1000 1150 1275 1350 1600	
NS (NS6100D) Machine roomless passenger elevator (Australian Standard)	1.0 1.6 1.75 2.0	630 800 1000 1150 1275 1350 1600	
NS 8600 Machine roomless passenger elevator	0.5 1.0 1.6	1800 2000 2700	
NVS (RICH-MRLV) Machine roomless panoramic passenger elevator	1.0 1.6 1.75	800 1000	
QVS (RICH-V) Small machineroom panoramic passenger elevator	1.0 1.6 1.75	630 800 1000	
FS Cargo elevator	0.5 1.0	2000 3000	
BS Hospital elevator	0.25 0.5	5000	
ZS Swing door villa lift	1.0 1.6 1.75 2.0 2.5		
ZS Auto door villa lift	0.25 0.4	320 400	
QS6100 High speed passenger elevator	0.25 0.4	320 400	
NAVI Super high speed passenger elevator	3.0-4.0	1000-1600	
NS(CHIO-II-MRLA) Machine roomless passenger elevator (Russia Standard)	5.0 6.0 7.0 8.0	1350 1600 2000	
MS(CHOI-II A) Small machineroom passenger elevator (Russia Standard)	1.0 1.6 1.75	400 630 800 1000	
RS9200 Service lift	1.0 1.6 1.75	400 630 800 1000	

MS (CHOI-II)

TECHNOLOGY LEADS THE MARKET
SERVICES CREATE VALUE

SHENYANG YUANDA INTELLECTUAL INDUSTRY GROUP CO., LTD.

CONTACT US

KAZAKHSTAN OVERSEAS BRANCH

E-mail:blt.kz@bltcn.cn
Tel:+86 24 25162893

CENTRAL-ASIA BRANCH

E-mail:blt.cis@bltcn.cn
Tel:+86 24 25162836

AFRICAN BRANCH

E-mail:blt.africa@bltcn.cn
Tel:+86 24 25162875

PAPUA NEW GUINEA BRANCH

E-mail:blt.oceania@bltcn.cn
Tel:+86 24 25162875

AUSTRALIA OVERSEAS BRANCH

E-mail:blt.au@bltcn.cn
Tel:+86 24 25162863

MOSCOW OVERSEAS BRANCH

E-mail:zapad.russia@bltcn.cn
Tel:+86 24 25162890

RUSSIAN EASTERN BRANCH

E-mail:vostok.russia@bltcn.cn
Tel:+86 24 25162894

EUROPEAN BRANCH

E-mail:blt.europe@bltcn.cn
Tel:+86 24 25162876

SOUTH AFRICA BRANCH

E-mail:s.africa@bltcn.cn
Tel:+86 24 25162865

KUWAIT BRANCH

E-mail:vostok.russia@bltcn.cn
Tel:+86 24 25162868

MEXICO BRANCH

E-mail:blt.centralamerica@bltcn.cn
Tel:+86 24 25162769

INDIA BRANCH

E-mail:blt.india@bltcn.cn
Tel:+86 24 25162850

VIETNAM AND THAILAND BRANCH

E-mail:blt.yt@bltcn.cn
Tel:+86 24 25162850

CHILE BRANCH

E-mail:blt.southamerica@bltcn.cn
Tel:+86 24 25162770

COLUMBIA BRANCH

E-mail:blt.america@bltcn.cn
Tel:+86 24 25162767

IRAN BRANCH

E-mail:blt.iran@bltcn.cn
Tel:+86 24 25162854

UNITED ARAB EMIRATES BRANCH

E-mail:blt.jjyu@bltcn.cn
Tel:+86 24 25162857

SINGAPORE BRANCH

E-mail:blt.sg@bltcn.cn
Tel:+86 24 25162849

MALAYSIA,INDONESIA AND PHILIPPINES BRANCH

E-mail:blt.asia@bltcn.cn
Tel:+86 24 25162858

NORTH KOREAN BRANCH

E-mail:blt.korea@bltcn.cn
Tel:+86 24 25162859

MONGOLIA OVERSEAS BRANCH

E-mail:blt_mn@bltcn.cn
Tel:+976 99057821

PERU OVERSEAS BRANCH

E-mail:blt.peru@bltcn.cn
Tel:+86 24 25162767

BALTIC SEA BRANCH

E-mail:blt.baltic@bltcn.cn
Tel:+86 24 25162785

SHENYANG YUANDA INTELLECTUAL INDUSTRY GROUP CO., LTD.

Add: No.27,Development Road,Shenyang Economic&Technology
Development Zone,China

P.C: 110027

Fax:+86 24 25162790 +86 24 25162844

http://www.bltelevator.com



SHENYANG YUANDA INTELLECTUAL INDUSTRY GROUP CO., LTD.

TECHNOLOGY LEADS THE MARKET
SERVICES CREATE VALUE

BRILLIANT ELEVATOR

- No.1 Chinese Brand
- Chinese Pride
- Trust by the world

Comparing to the renowned world-brand elevator, "Chinese brand" is becoming the step leader worldwide by providing ideal service to global prominent buildings. As China is continuously making science and technology model, we've been dedicating to make each intellectual traveling in the building more safe, comfortable and convenient.

After years of diligent effort, BLT, with its own intellectual property rights, has established more than 120 sales and service network worldwide including 6 wholly-owned and 1 jointed subsidiaries respectively in Germany, Australia, Singapore, Mongolia, Peru, and Morocco. In addition, we are expanding our global sales and service network by advancing oversea manufactures setup and simultaneously providing professional, efficient, and convenient service to our widespread clients via "Lifelong VIP Service".

Stock Code: 002689.SZ

China Well-know Trademark

National Customer Satisfaction Enterprise

National Customer Satisfaction Service





YUANDA GROUP

CREATE A HARMONIOUS WORLD OF FAMILY

■ Shenyang Yuanda Enterprise Group, constituted by Shenyang Yuanda Aluminum Industry Engineering Group, Shenyang Yuanda Intellectual Industry Group, and Shenyang Yuanda Mechanical & Electrical Equipment Group, is a large-scale international enterprise group specializing in curtain wall cladding systems, elevator manufacturing, mechanical and electrical equipment, wind power, integrated doors and windows, and environmental engineering. The headquarter is located in the Equipment Manufacturing Base of China – Shenyang City. After 19 years of innovation and development, Yuanda has established four manufacturing bases in Shenyang, Shanghai, Chengdu, and Foshan.

■ The full operation of the 1.9 square kilometers Yuanda Modern Industrial Park which located in the western Shenyang Industrial Corridor marks the birth of the world's largest curtain wall and elevator manufacturing base.

■ Yuanda Enterprise Group has opened up the high-end markets taking the United States and Japan as the center, the Southeast Asia market taking Singapore as the center, the European market taking United Kingdom and Germany as the center, the Middle East market taking U.A.E. as the center, the North Africa market taking Algiers as the center, and the Russia Federation market taking Moscow as the center. Its global sales and service network cover six continents all over the world, fully realizing the function of a comprehensive network of global business and service integration and radiation.

■ With unending spirit of innovation and pursuit of "high quality, high technology, and high-end markets" branding, Yuanda has won the trust of the world.

■ At present, projects constructed by Yuanda has been all over the world; the Russian Federation Tower, building height of 509 meters as the "tallest building in Europe"; the most difficult curtain wall engineering in the world – Japan COCOON Tower; Beijing 2008 Olympic National Swimming Stadium, the "Water Cube" and National Stadium the "Bird's Nest" has become unique landmark buildings in the world; Shanghai World Expo 2010 permanent stadium – the Expo Theme Pavilion and the Expo Center; project with the largest area in single contract in world curtain wall projects, Dubai Business Bay; the highest contract amount of a single contract, Abu Dhabi Commercial Center; Beijing New Poly Plaza, "the tallest building in South China" – Shenzhen Jingji Tower, Shanghai Oriental Art Center and other global landmark projects are all from Yuanda Enterprise Group.

■ Yuanda has always been seeking for reputation and market with quality, realizing the perfect combination of world-class technology, talents, and first-class equipment, thus the continuous expansion of the core business of Yuanda is becoming the world-class R&D and talents centers of the elevator industry.

■ Yuanda believes in the philosophy of "To do things honestly, to treat people sincerely", hoping with all of our friends around the world to build the Yuanda "world family". Yuanda wishes all the sincere people around the world have brilliant prospects!

SHENYANG YUANDA INTELLECTUAL INDUSTRY GROUP CO., LTD.

■ SHENYANG YUANDA INTELLECTUAL INDUSTRY GROUP CO., LTD. (The former name is Shenyang Brilliant Elevator Co., Ltd) (002689.SZ) is found in September, 2001, a professional elevator manufacturer engaged in the developing, designing, manufacturing, selling, installation, and after-sales service of complete elevator products. BLT has passed ISO9001:2008 Quality System Certificate, ISO14001 Certificate of Environment Management System and GB/T28001 Occupational Health and Safety Management System Certificate. In addition, BLT products have all obtained the CE certification of EU, GOST certification of Russia and CSA certificate of North America.

■ In 2010, the company built the Elevator Industrial Park in Shenyang west industry corridor for international management. The factory covers an area of 480 thousand square meters. This is the world important developing and manufacturing base of elevator. After years of effort, BLT has set up more than 220 sales service branches both at home and abroad, 6 wholly-owned subsidiaries and one joint-stock subsidiary in Germany, Australia, Singapore, Mongolia, Peru and Morocco, building a world-wide sales service network, and found worldwide sales and service network.

■ The company owns modern R&D center. The 177 meters high elevator test tower in the center of the factory is currently the highest one in China, with 11 test shafts, and a 10m/s high speed elevator technological test being feasible. The completed test and inspection center owns 12 libraries, one trial factory, and is equipped with 77 sets of advanced test/inspection devices. Besides, all the kinds of performance tests of complete elevators and components can be carried out in the center, which provides advanced, scientific and powerful guarantee for the research, development and stabilization of products.

TECHNOLOGY LEADS THE MARKET
SERVICES CREATE VALUE



26 thousand square meters large single workshop (multiple)



AMADA EMK3510NT turret punch



AMADA VIPROS-357Q Numerically Controlled Turret Punch Press

GLOBAL LEADER IN PRODUCTION EQUIPMENT



AMADA Flying Optics Laser Machine FO-3015



TRUMATIC L 3030, TRUMPF, Germany



Horizontal Machining Center



Tunnel type ultrasonic cleaning machine



Numerical Control Vertical turning flexible manufacturing cell



Salvagnini' s(S4+P4) Complete and Flexible Sheet Metal Product Lines, Italy(two)

MS (CHOI-IIJ)

Small Machine Room Passenger Elevator

Safety and reliability, Energy saving and environmental protection, stability and comfort, easy and convenient



MS(CHOI-IIJ) Small Machine Room Elevator...

Compact small machine room design

Compared with traditional machine room elevator, CHOI II machine room area of the elevator has reduced up to 60% machine room space.

Ultra-thin control cabinet

Ultra-thin control cabinet independently developed and designed by Brilliant Elevator adopts mature integrated circuit technology to improve anti-interference ability and efficiently improves utilization of machine room space by reducing the wiring and width of control cabinet.

Product series

Speed up to 2.5m/s, load up to 1150kg, passenger number up to 15 people
The elevator adopts brand new control system, driving member and structure design to ensure the stable operation in details.

PERFECT INTEGRATED CONTROL DRIVING SYSTEM

- Owning reliable logic control kinetic energy and powerful driving performance
- Having strong extended capability and abundant function
- Being much closer to customer demand and providing safety protection for passengers to maximum extent
- Simple operation, supporting debugging in the car, starting without weighing compensation, adapting to change in load, constantly exchanging communication information, low failure rate and reducing maintenance cost
- Having strong compatibility switching between synchronous and asynchronous host machine only needs software adjustment.
- Owning 32 bit processing chip the elevator responds more quickly.

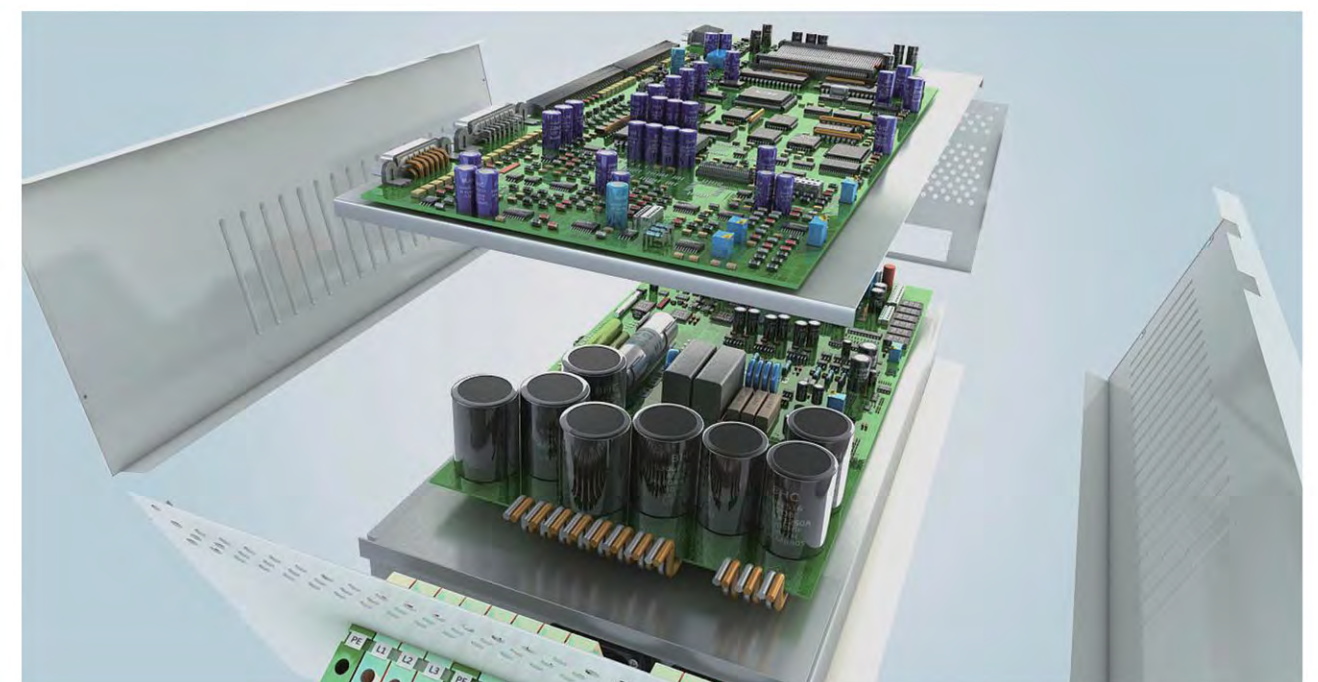
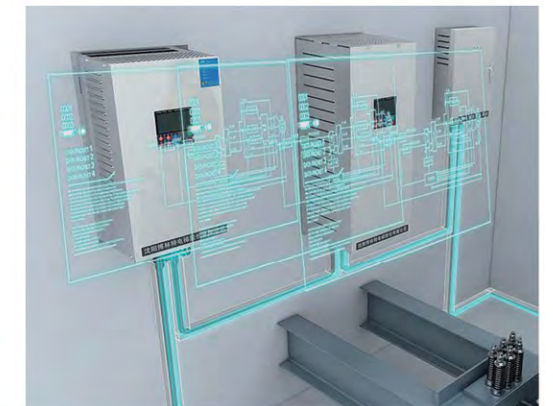

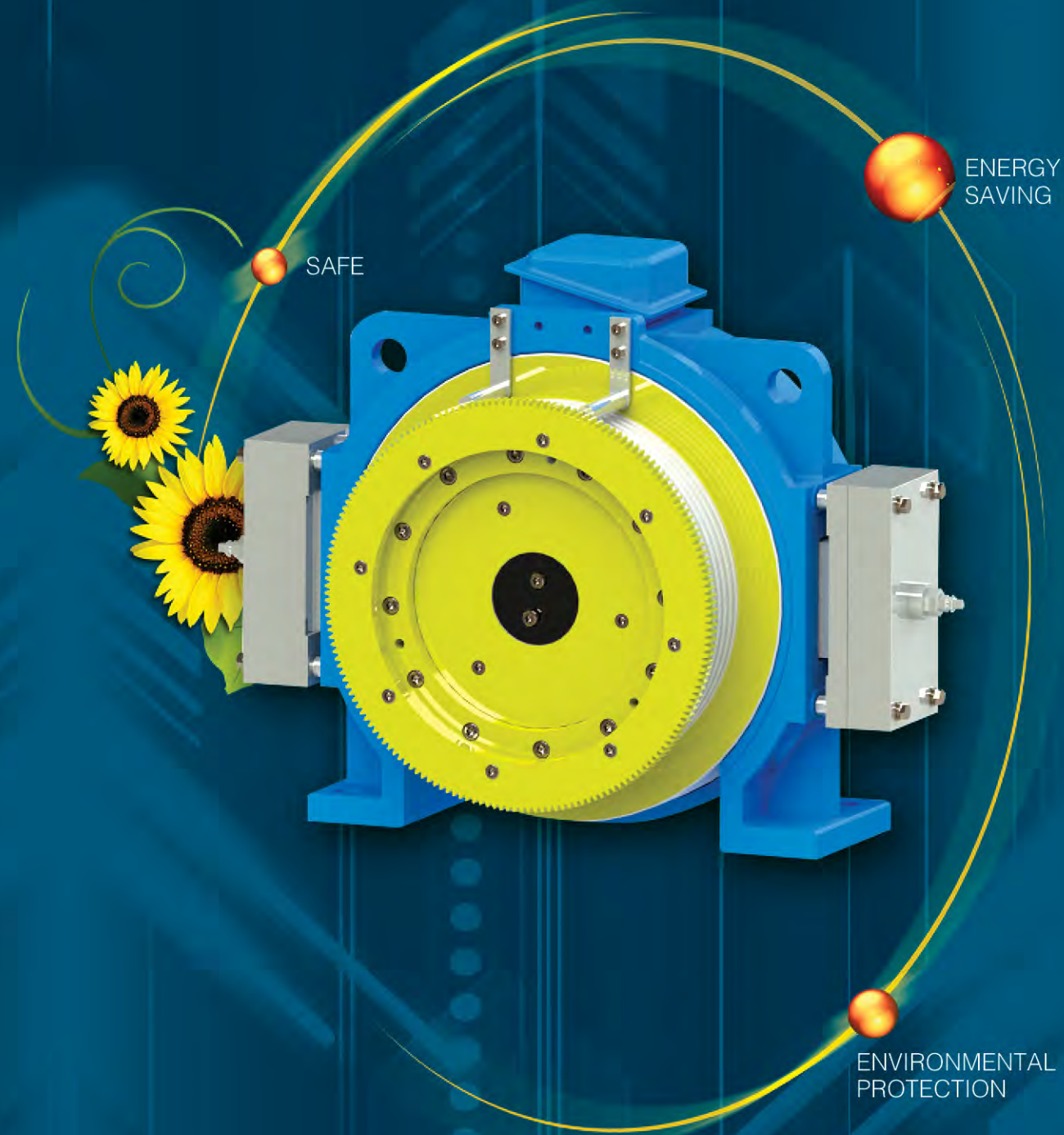

Original BLT factory brand traction machine

Miniaturization, thin shape, volume reduced by 30%, and all that provide architect with greater flexibility on space design, increase the efficiency of architectural space. Rotor consists of high-performance synchronous magnets, non-field current, greatly improving the running efficiency; reduce the energy consumption of about 40%

HIGH EFFICIENCY, ENERGY SAVING, ENVIRONMENTAL PROTECTION

○ Appearance

Exterior miniaturization and thinness reduce the volume by 30% and block brake further reduces the height providing greater flexibility design space for the architect and improving the utilization rate of the architectural space.

○ Energy saving

Rotor consists of high performance permanent magnets without excitation current, greatly improving operation efficiency and reducing the energy consumption of about 40%.

The series of product equip with self aligning roller bearing of a famous brand to ensure operation efficiency and long service life of driving host.

○ Environmental protection

It dispenses with the traditional worm gear reducer, reduces the noise by 10 decibels, without replacement of lubricating oil, eradicates oil pollution and enables free maintenance for a long time.

○ Safety

Brake test times as many as more than 2 million times

Brake redundancy design enables up running overspeed protection.

Excellent misoperation monitoring system of the brake ensures the safety of the passengers.

Unique intelligent thermal monitoring feedback system of drive host ensures the security of the traction system.

Performance of friction materials and encoder from Germany increases more than 10%.

Reduce energy consumption by about 40%



EXCELLENT BLT DOOR SYSTEM

○ Comfort

Innovative PWM pulse width modulation technology enables the door open and close much gentler.

Time-proven toothed belt transmission technology enables smooth movements of door open and close and reduces running noise.

○ Energy saving

Mature directly driven technology of permanent magnet synchronous dispenses with retarding mechanism and guarantees the transmission links without trouble.

○ Intelligence

The stable closed-loop system and door machine self-learning system ensure completion of automatic parameter setting.

The controller has built-in optimal curve so best door operation curve can be chosen according to building characteristics.

○ Safety

More than 3 million door open and close test ensures the product is safe and stable.

High precision encoder ensures the operation of door open is smoother and steadier.

Built-in door close force monitoring system ensures safety of passengers.

The system adopts unique anti-drop design which can still operate safely even after being impacted by 450J.

It has super light curtain protection function, good resistance to light interference and conforms to the EMC test standards.



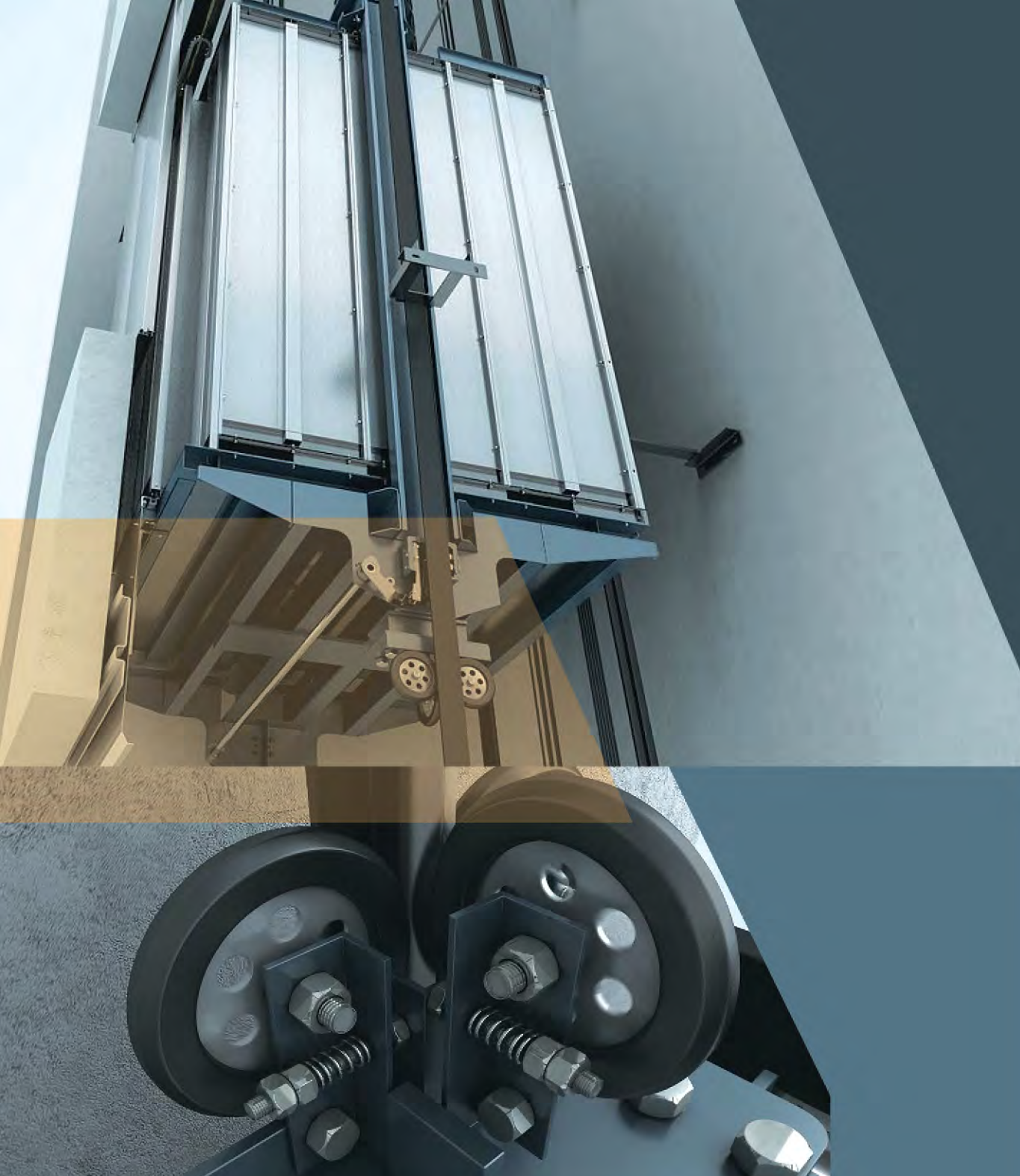

HIGH-END ELEVATOR DESIGN CONCEPT

Comprehensive application of roller guide shoe effectively reduces the running resistance, makes the elevator run more smoothly, reflects green environmental protection idea, without lubrication, and thoroughly gets rid of oil pollution in the shaft.

ULTRA-THIN HALL CALL BOX



Novel appearance, clear display

EASY TO FIX NO NEED CIVIL WORK OPENING

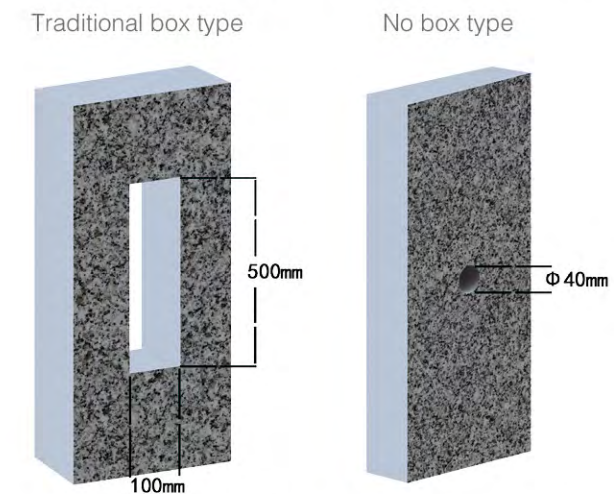

Traditional box type: need civil work opening, time consuming.
No box type: no need civil work preopening only need embedded pipeline, easy repair and maintenance.

CHROMIUM FREE AND FINGERPRINT PROOF PANEL

Advanced self cleaning appearance technology



Common material

Chromium free and fingerprint proof panel

No fingerprints board has high surface hardness, strong corrosion resistance and friction resistance; it has characteristics of novelty, environmental protection, great wearing property, strong stereoscopic effect, health and beauty, etc; Its Color is lasting clean, and it also has the feature of strong detergency, being easy to clean, resisting the fingerprint. The whole series of operation panel adopts fingerprint resistant plate.

ANTI OFF DESIGN

The elevator landing door adopts unique anti-dropping design to solve the problems, such as door panel deformation and dropping caused by external shocks.

The design has obtained China national patent: 201320169973.9

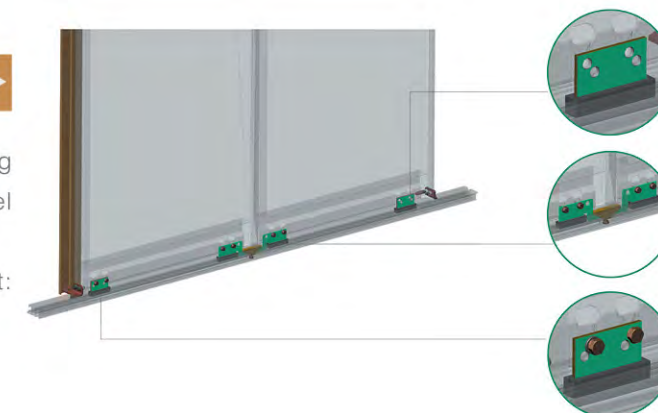

MEET

INDIVIDUALIZED NEED



K162 (Standard)

Elegant and tasteful car design is perfectly combined with concise and smooth car ceiling creating a comfortable and quiet space.



Car ceiling:	PS005 Painted steel sheet RAL1013, acrylic light cover
Car front wall:	Painted steel sheet RAL1013
Car side wall:	Painted steel sheet RAL1013
Door Transom:	Painted steel sheet RAL1013
Car door:	Painted steel sheet RAL1013
Floor:	Plastic floor, MA-018
COP:	C102Q SUS304 stainless fingerprint proof steel panel.

(computer drawing. May vary from the actual product)

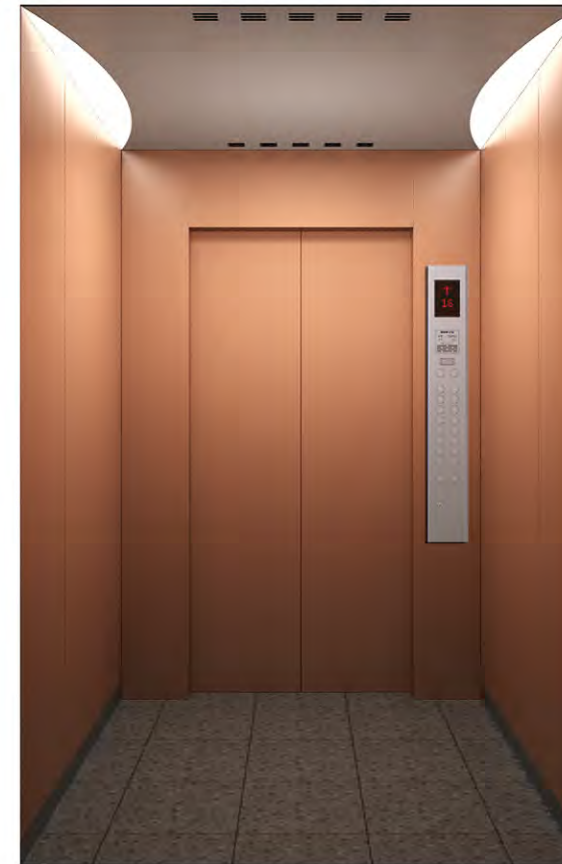

K163

Individualized car design and beautiful and tasteful inner decoration make passengers feel safe, comfortable and warm.

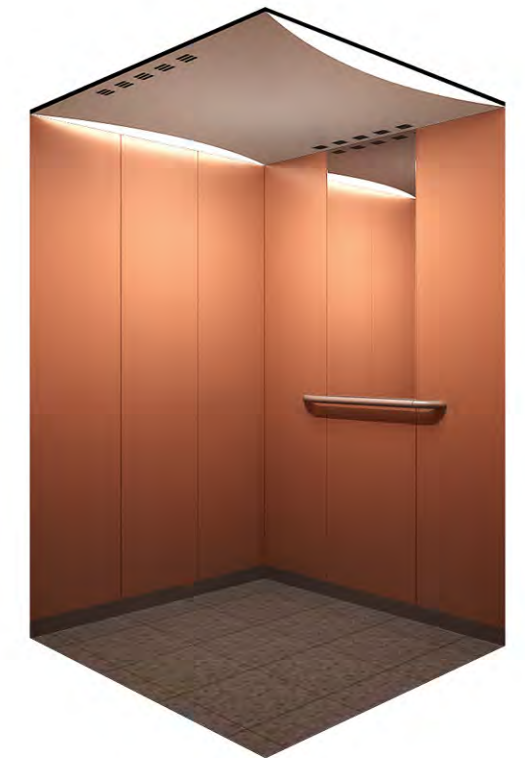

Car ceiling:	PS003 painted steel sheet RAL9003, acrylic light cover
Car front wall:	painted steel sheet RAL2003
Car side wall:	painted steel sheet RAL2003
Door Transom:	painted steel sheet RAL2003
Car door:	painted steel sheet RAL2003
Car rear wall:	painted steel sheet RAL2003 + Mirror finished stainless steel
Floor:	Plastic floor, MA-025
Handrail:	BLT-H112 painted RAL9003
COP:	C102Q SUS304 stainless fingerprint proof steel panel.

(computer drawing. May vary from the actual product)

MEET

INDIVIDUALIZED NEED



K164

Exquisite car design is combined with the arc-shaped decoration ceiling design effectively increasing car height and making passengers feel more comfortable.



Car ceiling:	PS004 painted steel sheet RAL9003, down light.
Car front wall:	Hairline stainless steel
Car side wall:	painted steel sheet RAL1034
Car rear wall:	Hairline stainless steel + Mirror finished stainless steel
Door Transom:	Hairline stainless steel
Car door:	Hairline stainless steel
Floor:	Plastic floor, MA-025
COP:	C102Q SUS304 stainless fingerprint proof steel panel.
Handrail:	BLT-H112 painted RAL9003

(computer drawing. May vary from the actual product)



K165

Exquisite car design is combined with the arc-shaped decoration ceiling design effectively increasing car height and making passengers feel more comfortable.



Car ceiling:	PD060 Hairline stainless steel, acrylic light cover, down light.
Car front wall:	Hairline stainless steel
Car 3-side wall:	Hairline stainless steel
Door Transom:	Hairline stainless steel
Car door:	Hairline stainless steel
Floor:	Plastic floor, SJ-008
COP:	C102Q SUS304 stainless fingerprint proof steel panel.

(computer drawing. May vary from the actual product)

MEET

INDIVIDUALIZED NEED



K166

Car design is compact and novel. Hairline stainless steel decoration is applied to car which is economical, beautiful and easy for maintenance.



Car ceiling:	PD057 Hairline stainless steel, acrylic light cover , down light. (Trap door can be equipped except elevators with load of 400-450kg, and elevators with load 630kg, car dimension 1400x1100.);
Car front wall:	Hairline stainless steel
Car 3-side wall:	Hairline stainless steel
Door Transom:	Hairline stainless steel
Car door:	Hairline stainless steel
Floor:	Plastic floor, SJ-008
COP:	C102Q SUS304 stainless fingerprint proof steel panel.

(computer drawing. May vary from the actual product)



K167

High quality hairline stainless steel, colorful steel sheet as well as elaborate car design ensure elevator quality.



Car ceiling:	PD060 Hairline stainless steel, acrylic light cover , down light.
Car front wall:	Colorful steel sheet LC002
Car 3-side wall:	Colorful steel sheet LC002
Door Transom:	Colorful steel sheet LC002
Car door:	Colorful steel sheet LC002
Floor:	Plastic floor, MA-025
COP:	C102Q SUS304 stainless fingerprint proof steel panel.

(computer drawing. May vary from the actual product)

MEET

INDIVIDUALIZED NEED



K168

Car design has the features of practicality, beauty, elaboration and concision creating a more easeful experience for passengers.



Car ceiling:	PD060 Hairline stainless steel, acrylic light cover , down light.
Car front wall:	Colorful steel sheet LB002
Car 3-side wall:	Colorful steel sheet LB002
Door Transom:	Colorful steel sheet LB002
Car door:	Colorful steel sheet LB002
Floor:	Plastic floor, SJ-004
COP:	C102Q SUS304 stainless fingerprint proof steel panel.

(computer drawing. May vary from the actual product)



K169

Bright and spacious car cage and elegant ceiling design with a concise decoration style makes the car looks nice and decent.



Car ceiling:	PD057 Hairline stainless steel, acrylic light cover , down light. (Trap door can be equipped except elevators with load of 400-450kg, and elevators with load 630kg, car dimension 1400x1100.)
Car front wall:	Colorful steel sheet LA001
Car 3-side wall:	Colorful steel sheet LA001
Door Transom:	Colorful steel sheet LA001
Car door:	Colorful steel sheet LA001
Floor:	Plastic floor, SJ-002A
COP:	C102Q SUS304 stainless fingerprint proof steel panel.

(computer drawing. May vary from the actual product)

MEET

INDIVIDUALIZED NEED



K204



Car ceiling:	PD115 Powder spray steel sheet RAL9002, white arc steel sheet, down lamp;
Front car wall:	Powder spray steel sheet RAL9002;
Transom:	Powder spray steel sheet RAL9002;
Car door:	Powder spray steel sheet RAL9002;
Three sides car wal:	Powder spray steel sheet RAL9002;
Car floor:	MA-025;
Operation panel:	C102Q 304 stainless steel fingerprint-proof panel.

(computer drawing. May vary from the actual product)



K205



Car ceiling:	PD060 Powder spray steel sheet RAL1013, acrylic lamp decoration, down lamp;
Front car wall:	Powder spray steel sheet RAL1013;
Transom:	Powder spray steel sheet RAL1013;
Car door:	Powder spray steel sheet RAL1013;
Three sides car wal:	Powder spray steel sheet RAL1013;
Car floor:	MA-025;
Operation panel:	C102Q 304 Stainless steel fingerprint-proof panel.

(computer drawing. May vary from the actual product)

MEET

INDIVIDUALIZED NEED



K206

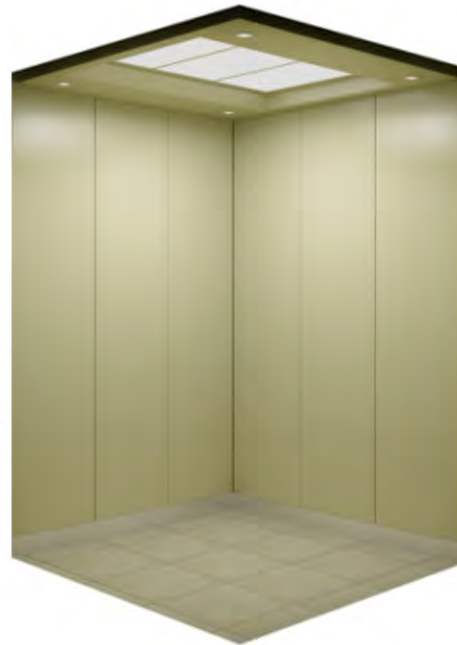

Car ceiling:	PD057 powder spray steel sheet RAL1013, acrylic lamp decoration, down lamp (Trap door can be equipped except elevators with load of 400–450kg, and elevators with load 630kg, car dimension 1400x1100.);
Front car wall:	Powder spray steel sheet RAL1013;
Transom:	Powder spray steel sheet RAL1013;
Car door:	Powder spray steel sheet RAL1013;
Three sides car wal:	Powder spray steel sheet RAL1013;
Car floor:	MA-018;
Operation panel:	C102Q 304 Stainless steel fingerprint-proof panel.

(computer drawing. May vary from the actual product)



K207



Car ceiling:	PD115 Hairline stainless steel, white arc steel sheet, down lamp;
Front car wall:	Colorful steel plate LC002;
Transom:	Colorful steel plate LC002;
Car door:	Colorful steel plate LC002;
Three sides car wal:	Colorful steel plate LC002;
Car floor:	MA-025;
Operation panel:	C102Q 304 stainless steel fingerprint-proof panel.

(computer drawing. May vary from the actual product)

MEET

INDIVIDUALIZED NEED



K208



Car ceiling:	PD115 Hairline stainless steel, white arc steel sheet, down lamp;
Front car wall:	Hairline stainless steel;
Transom:	Hairline stainless steel;
Car door:	Hairline stainless steel;
Three sides car wall:	Hairline stainless steel;
Car floor:	Plastic MA-025;
Operation panel:	C102Q 304 stainless steel fingerprint-proof panel.

(computer drawing. May vary from the actual product)

MEET

INDIVIDUALIZED NEED



PS004 (only painted)



PS003 (only painted)

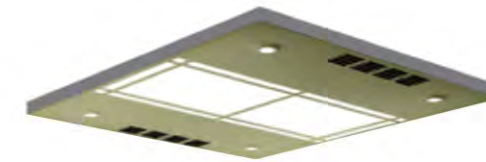

PS005 (only painted RAL1013)
(Standard)



PD060



PD057 (trap door)



PS005
(only painted RAL6019, 6027, 7004, 9003)



PD115

PS005	powder spray steel sheet RAL1013;standard
PS005	Powder spray steel sheet RAL6019; powder spray steel sheet RAL6027; powder spray steel sheet RAL7004; powder spray steel sheet RAL9003;
PS003	Powder spray steel sheet RAL1013; powder spray steel sheet RAL6019; powder spray steel sheet RAL6027; powder spray steel sheet RAL7004; powder spray steel sheet RAL9003;
PS004	Powder spray steel sheet RAL1013; powder spray steel sheet RAL6019; powder spray steel sheet RAL6027; powder spray steel sheet RAL7004; powder spray steel sheet RAL9003;
PD057	Hairline stainless steel; mirror stainless steel; etching stainless steel; Powder spray steel sheet RAL1013; powder spray steel sheet RAL6019; powder spray steel sheet RAL6027; powder spray steel sheet RAL7004; powder spray steel sheet RAL9003. (Trap door can be equipped except elevators with load of 400-450kg, and elevators with load 630kg, car dimension 1400x1100.);
PD060	Hairline stainless steel; mirror stainless steel; etching stainless steel; powder spray steel sheet RAL1013; powder spray steel sheet RAL6019; powder spray steel sheet RAL6027; powder spray steel sheet RAL7004; powder spray steel sheet RAL9003;
PD115	Hairline stainless steel; powder spray steel sheet RAL1013; powder spray steel sheet RAL6019; powder spray steel sheet RAL6027; powder spray steel sheet RAL7004; powder spray steel sheet RAL9003; powder spray steel sheet RAL9002.

CAR FLOOR

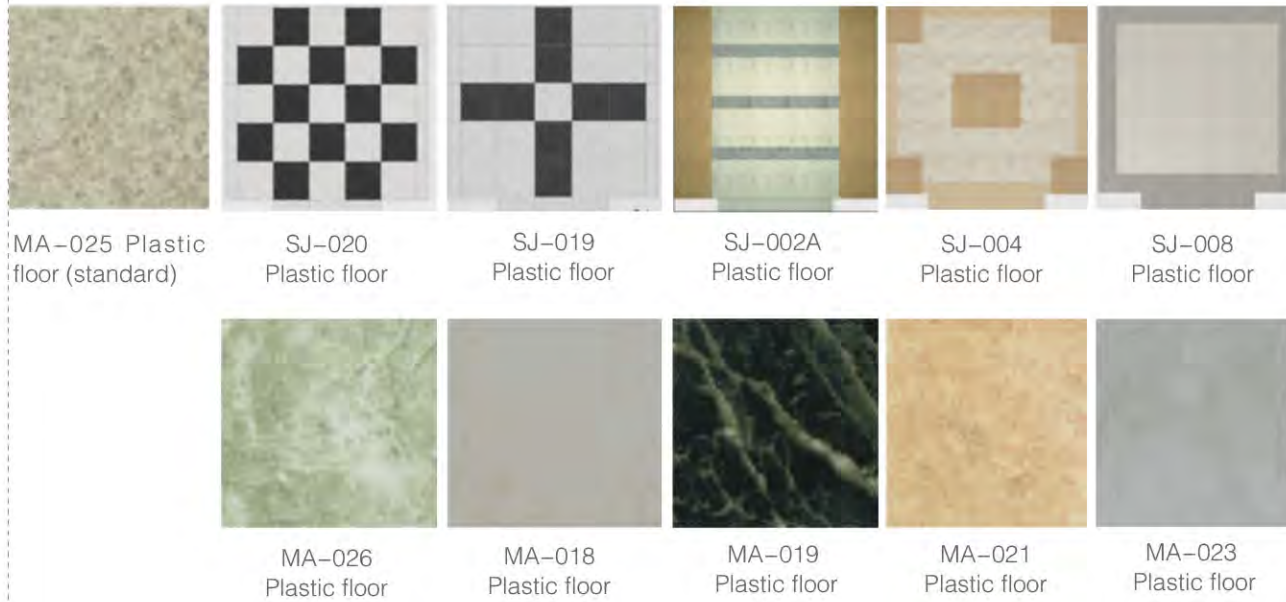

MATERIAL

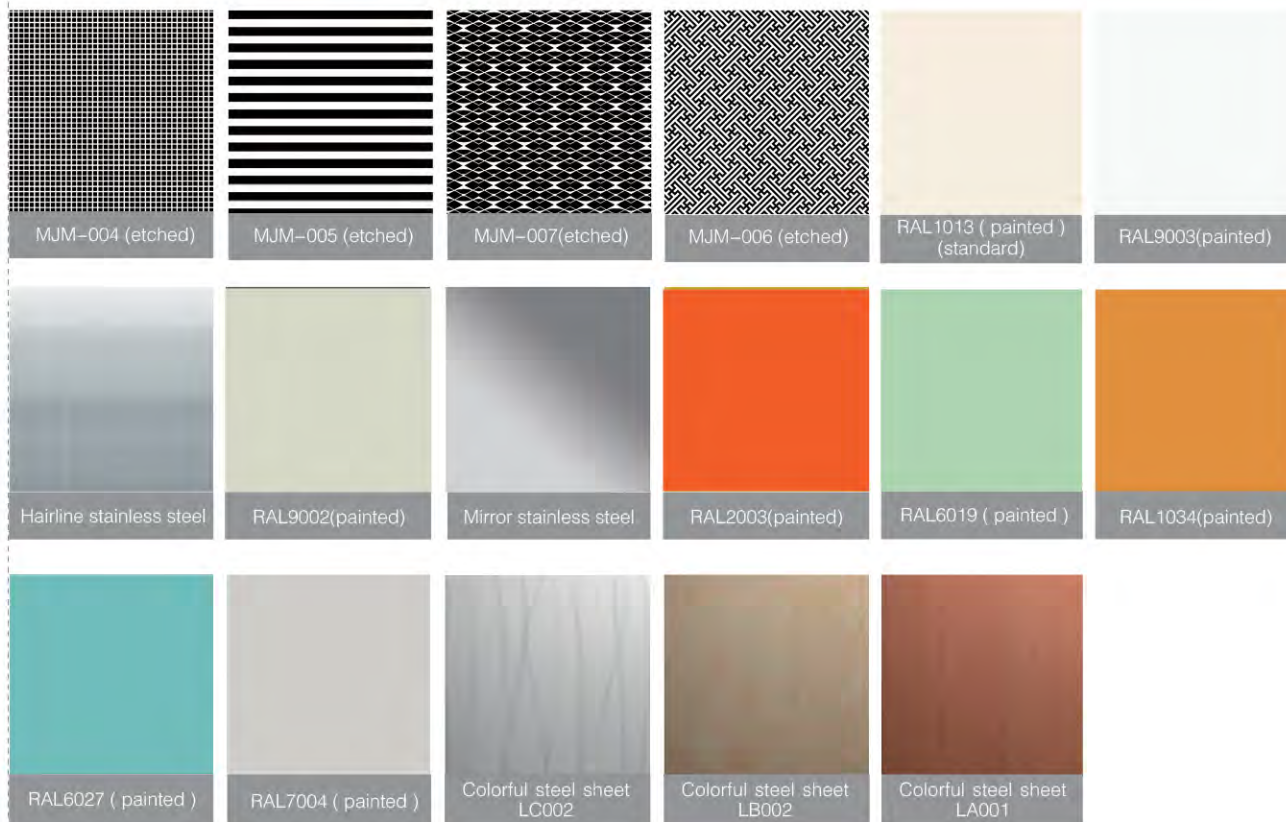

HANDRAIL



BLT-H005 (Mirror stainless steel)



BLT-H006 (Mirror stainless steel + Acrylic + golden titanium mirror stainless steel)



BLT-H007 (Mirror stainless steel)



BLT-H009 (Hairline stainless steel)



BLT-H012 (Mirror stainless steel + sand blasting stainless steel)



H011 (Stainless steel)



H112 (Painted RAL9003)

COP & HALL CALL



C102Q	Aluminum alloy frame 304 stainless steel fingerprint-proof panel; round white light no Braille button; dynamic dot matrix display
C103Q	Aluminum alloy frame 304 stainless steel fingerprint-proof panel; square white light no Braille button; dynamic dot matrix display
C126Q	Aluminum alloy frame 304 stainless steel fingerprint-proof panel; round white light Braille button; dynamic dot matrix display
C127Q	Aluminum alloy frame 304 stainless steel fingerprint-proof panel; square white light Braille button; dynamic dot matrix display
C106Q	Aluminum alloy frame 304 stainless steel fingerprint-proof panel; round white light no Braille button; static segment code LCD (black text on white background)
C109Q	Aluminum alloy frame 304 stainless steel fingerprint-proof panel; square white light no Braille button; static segment code LCD (black text on white background)
C130Q	Aluminum alloy frame 304 stainless steel fingerprint-proof panel; round white light Braille button; static segment code LCD (black text on white background)
C133Q	Aluminum alloy frame 304 stainless steel fingerprint-proof panel; square white light Braille button; static segment code LCD (black text on white background)

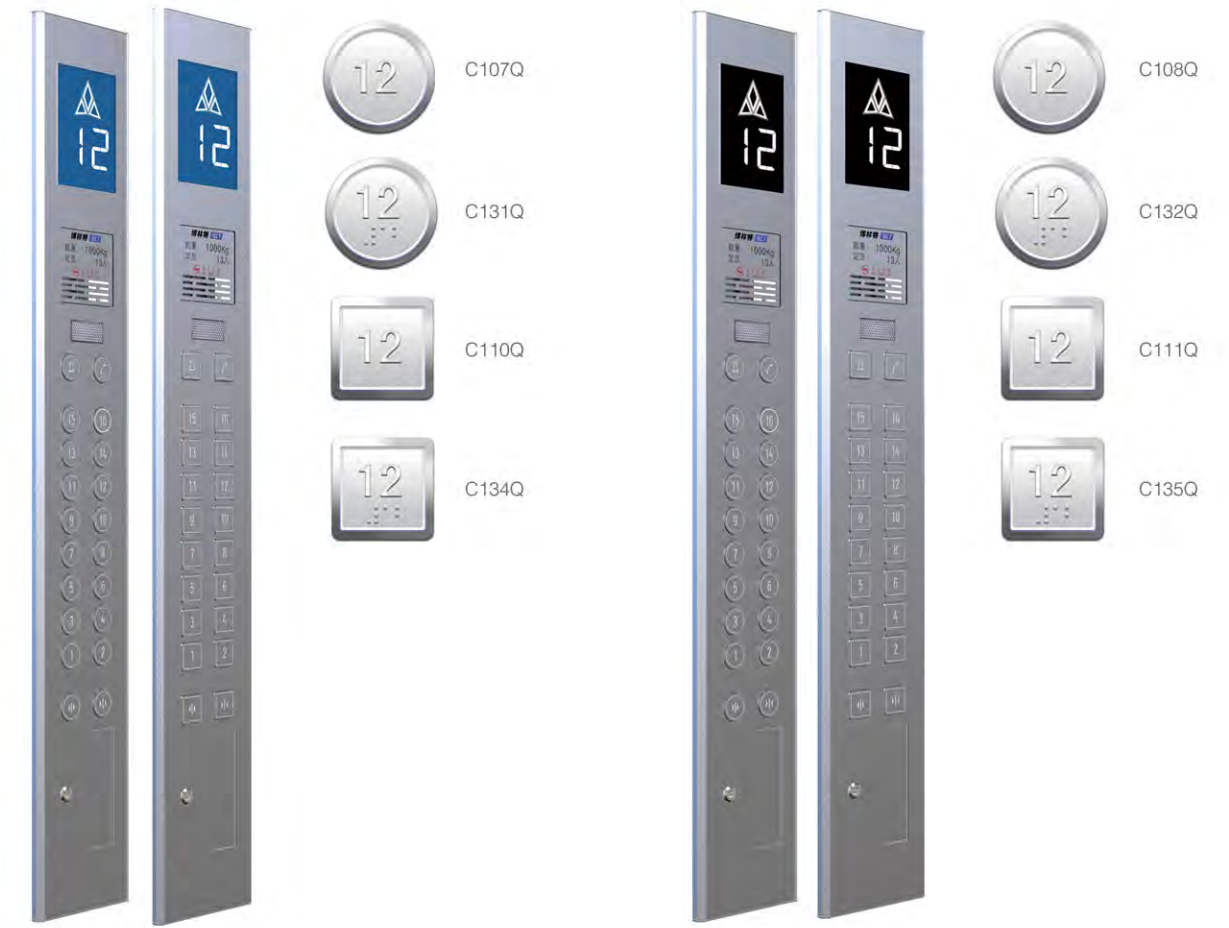

C107Q	Aluminum alloy frame 304 stainless steel fingerprint-proof panel; round white light no Braille button; static segment code LCD (white text on blue background)
C110Q	Aluminum alloy frame 304 stainless steel fingerprint-proof panel; square white light no Braille button; static segment code LCD (white text on blue background)
C131Q	Aluminum alloy frame 304 stainless steel fingerprint-proof panel; round white light Braille button; static segment code LCD (white text on blue background)
C134Q	Aluminum alloy frame 304 stainless steel fingerprint-proof panel; square white light Braille button; static segment code LCD (white text on blue background)
C108Q	Aluminum alloy frame 304 stainless steel fingerprint-proof panel; round white light no Braille button; static segment code LCD (white text on black background)
C111Q	Aluminum alloy frame 304 stainless steel fingerprint-proof panel; square white light no Braille button; static segment code LCD (white text on black background)
C132Q	Aluminum alloy frame 304 stainless steel fingerprint-proof panel; round white light Braille button; static segment code LCD (white text on black background)
C135Q	Aluminum alloy frame 304 stainless steel fingerprint-proof panel; square white light Braille button; static segment code LCD (white text on black background)

(computer drawing. May vary from the actual product)

COP & HALL CALL



C137Q	Aluminum alloy frame 304 stainless steel fingerprint-proof panel; round white light no Braille button; color LCD
C139Q	Aluminum alloy frame 304 stainless steel fingerprint-proof panel; square white light no Braille button; color LCD
C136Q	Aluminum alloy frame 304 stainless steel fingerprint-proof panel; round white light Braille button; color LCD
C138Q	Aluminum alloy frame 304 stainless steel fingerprint-proof panel; square white light Braille button; color LCD

(computer drawing. May vary from the actual product)



H109A	304 hairline stainless steel panel; round white light no Braille button; dynamic dot matrix display
H109AB	304 hairline stainless steel panel; round white light no Braille button; dynamic dot matrix display, duplex
H110A	304 hairline stainless steel panel; square white light no Braille button; dynamic dot matrix display
H110AB	304 hairline stainless steel panel; square white light no Braille button; dynamic dot matrix display, duplex
H165A	304 hairline stainless steel panel; round white light Braille button; dynamic dot matrix display
H165AB	304 hairline stainless steel panel; round white light Braille button; dynamic dot matrix display, duplex
H166A	304 hairline stainless steel panel; square white light Braille button; dynamic dot matrix display
H166AB	304 hairline stainless steel panel; square white light Braille button; dynamic dot matrix display, duplex



H112A	304 hairline stainless steel panel; round white light no Braille button; static segment code LCD (black text on white background)
H112AB	304 hairline stainless steel panel; round white light no Braille button; static segment code LCD (black text on white background), duplex
H115A	304 hairline stainless steel panel; square white light no Braille button; static segment code LCD (black text on white background)
H115AB	304 hairline stainless steel panel; square white light no Braille button; static segment code LCD (black text on white background), duplex
H169A	304 hairline stainless steel panel; round white light Braille button; static segment code LCD (black text on white background)
H169AB	304 hairline stainless steel panel; round white light Braille button; static segment code LCD (black text on white background), duplex
H172A	304 hairline stainless steel panel; square white light Braille button; static segment code LCD (black text on white background)
H172AB	304 hairline stainless steel panel; square white light Braille button; static segment code LCD (black text on white background), duplex

COP & HALL CALL



H113A	304 hairline stainless steel panel; round white light no Braille button; static segment code LCD (white text on blue background)
H113AB	304 hairline stainless steel panel; round white light no Braille button; static segment code LCD (white text on blue background), duplex
H116A	304 hairline stainless steel panel; square white light no Braille button; static segment code LCD (white text on blue background)
H116AB	304 hairline stainless steel panel; square white light no Braille button; static segment code LCD (white text on blue background), duplex
H170A	304 hairline stainless steel panel; round white light Braille button; static segment code LCD (white text on blue background)
H170AB	304 hairline stainless steel panel; round white light Braille button; static segment code LCD (white text on blue background), duplex
H173A	304 hairline stainless steel panel; square white light Braille button; static segment code LCD (white text on blue background)
H173AB	304 hairline stainless steel panel; square white light Braille button; static segment code LCD (white text on blue background), duplex



H114A	304 hairline stainless steel panel; round white light no Braille button; static segment code LCD (white text on black background)
H114AB	304 hairline stainless steel panel; round white light no Braille button; static segment code LCD (white text on black background), duplex
H117A	304 hairline stainless steel panel; square white light no Braille button; static segment code LCD (white text on black background)
H117AB	304 hairline stainless steel panel; square white light no Braille button; static segment code LCD (white text on black background), duplex
H171A	304 hairline stainless steel panel; round white light Braille button; static segment code LCD (white text on black background)
H171AB	304 hairline stainless steel panel; round white light Braille button; static segment code LCD (white text on black background), duplex
H174A	304 hairline stainless steel panel; square white light Braille button; static segment code LCD (white text on black background)
H174AB	304 hairline stainless steel panel; square white light Braille button; static segment code LCD (white text on black background), duplex

(computer drawing. May vary from the actual product)



H118A	Aluminum alloy frame 304 stainless steel fingerprint-proof panel; round white light no Braille button; static segment code LCD (black text on white background)
H118AB	Aluminum alloy frame 304 stainless steel fingerprint-proof panel; round white light no Braille button; static segment code LCD (black text on white background), duplex
H121A	Aluminum alloy frame 304 stainless steel fingerprint-proof panel; square white light no Braille button; static segment code LCD (black text on white background)
H121AB	Aluminum alloy frame 304 stainless steel fingerprint-proof panel; square white light no Braille button; static segment code LCD (black text on white background), duplex
H175A	Aluminum alloy frame 304 stainless steel fingerprint-proof panel; round white light Braille button; static segment code LCD (black text on white background)
H175AB	Aluminum alloy frame 304 stainless steel fingerprint-proof panel; round white light Braille button; static segment code LCD (black text on white background), duplex
H178A	Aluminum alloy frame 304 stainless steel fingerprint-proof panel; square white light Braille button; static segment code LCD (black text on white background)
H178AB	Aluminum alloy frame 304 stainless steel fingerprint-proof panel; square white light Braille button; static segment code LCD (black text on white background), duplex



H119A	Aluminum alloy frame 304 stainless steel fingerprint-proof panel; round white light no Braille button; static segment code LCD (white text on blue background)
H119AB	Aluminum alloy frame 304 stainless steel fingerprint-proof panel; round white light no Braille button; static segment code LCD (white text on blue background), duplex
H122A	Aluminum alloy frame 304 stainless steel fingerprint-proof panel; square white light no Braille button; static segment code LCD (white text on blue background)
H122AB	Aluminum alloy frame 304 stainless steel fingerprint-proof panel; square white light no Braille button; static segment code LCD (white text on blue background), duplex
H176A	Aluminum alloy frame 304 stainless steel fingerprint-proof panel; round white light Braille button; static segment code LCD (white text on blue background)
H176AB	Aluminum alloy frame 304 stainless steel fingerprint-proof panel; round white light Braille button; static segment code LCD (white text on blue background), duplex
H179A	Aluminum alloy frame 304 stainless steel fingerprint-proof panel; square white light Braille button; static segment code LCD (white text on blue background)
H179AB	Aluminum alloy frame 304 stainless steel fingerprint-proof panel; square white light Braille button; static segment code LCD (white text on blue background), duplex

COP & HALL CALL



H120A/H120AB

H177A/H177AB

H123A/H123AB

H180A/H180AB

H120A	Aluminum alloy frame 304 stainless steel fingerprint-proof panel; round white light no Braille button; static segment code LCD (white text on black background)
H120AB	Aluminum alloy frame 304 stainless steel fingerprint-proof panel; round white light no Braille button; static segment code LCD (white text on black background), duplex
H123A	Aluminum alloy frame 304 stainless steel fingerprint-proof panel; square white light no Braille button; static segment code LCD (white text on black background)
H123AB	Aluminum alloy frame 304 stainless steel fingerprint-proof panel; square white light no Braille button; static segment code LCD (white text on black background), duplex
H177A	Aluminum alloy frame 304 stainless steel fingerprint-proof panel; round white light Braille button; static segment code LCD (white text on black background)
H177AB	Aluminum alloy frame 304 stainless steel fingerprint-proof panel; round white light Braille button; static segment code LCD (white text on black background), duplex
H180A	Aluminum alloy frame 304 stainless steel fingerprint-proof panel; square white light Braille button; static segment code LCD (white text on black background)
H180AB	Aluminum alloy frame 304 stainless steel fingerprint-proof panel; square white light Braille button; static segment code LCD (white text on black background), duplex



H124C

HB333

H126C

HB334

H124C	Circular arc ultra thin wall-mounted no display, 304 hairline stainless steel panel; round white light no Braille button
H126C	Circular arc ultra thin wall-mounted no display, 304 hairline stainless steel panel; square white light no Braille button
HB333	Circular arc ultra thin wall-mounted no display, 304 hairline stainless steel panel; round white light Braille button
HB334	Circular arc ultra thin wall-mounted no display, 304 hairline stainless steel panel; square white light Braille button



H182A/H182AB

H181A/H181AB

H184A/H184AB

H183A/H183AB

H182A	304 hairline stainless steel panel; round white light no Braille button; color LCD
H182AB	304 hairline stainless steel panel; round white light no Braille button; color LCD, duplex
H184A	304 hairline stainless steel panel; square white light no Braille button; color LCD
H184AB	304 hairline stainless steel panel; square white light no Braille button; color LCD, duplex
H181A	304 hairline stainless steel panel; round white light Braille button; color LCD
H181AB	304 hairline stainless steel panel; round white light Braille button; color LCD, duplex
H183A	304 hairline stainless steel panel; square white light Braille button; color LCD
H183AB	304 hairline stainless steel panel; square white light Braille button; color LCD, duplex



H125C

HB330

H127C

HB331

H125C	Aluminum alloy frame 304 stainless steel fingerprint-proof panel; no display, round white light no Braille button
H127C	Aluminum alloy frame 304 stainless steel fingerprint-proof panel; no display, square white light no Braille button
HB330	Aluminum alloy frame 304 stainless steel fingerprint-proof panel; no display, round white light Braille button
HB331	Aluminum alloy frame 304 stainless steel fingerprint-proof panel; no display, square white light Braille button

(computer drawing. May vary from the actual product)

COP & HALL CALL



H185A	Aluminum alloy frame 304 stainless steel fingerprint-proof panel; round white light no Braille button; dynamic dot matrix display
H185AB	Aluminum alloy frame 304 stainless steel fingerprint-proof panel; round white light no Braille button; dynamic dot matrix display, duplex
H187A	Aluminum alloy frame 304 stainless steel fingerprint-proof panel; square white light no Braille button; dynamic dot matrix display
H187AB	Aluminum alloy frame 304 stainless steel fingerprint-proof panel; square white light no Braille button; dynamic dot matrix display, duplex
H186A	Aluminum alloy frame 304 stainless steel fingerprint-proof panel; round white light Braille button; dynamic dot matrix display
H186AB	Aluminum alloy frame 304 stainless steel fingerprint-proof panel; round white light Braille button; dynamic dot matrix display, duplex
H188A	Aluminum alloy frame 304 stainless steel fingerprint-proof panel; square white light Braille button; dynamic dot matrix display
H188AB	Aluminum alloy frame 304 stainless steel fingerprint-proof panel; square white light Braille button; dynamic dot matrix display, duplex

(computer drawing. May vary from the actual product)



HF300	Hairline stainless steel panel; circular arc panel upper and lower ends
HF330	Aluminum alloy frame 304 stainless steel fingerprint-proof panel
H111G	Hairline stainless steel panel; dot matrix display
H137G	Hairline stainless steel panel; 6.4-inch segment code LCD
H130G	Hairline stainless steel panel; color LCD



C155G
304 hairline stainless steel panel; wall-mounted structure; round white light stainless steel sand blasting contact face Braille button

HALL LANTERNS



HD017
Hairline stainless steel panel; Translucent acrylic, Round amber light

HD018
Hairline stainless steel panel; Translucent acrylic, Triangular amber light

HD019
Hairline stainless steel panel; Translucent acrylic, square amber light

COP & HALL CALL



Standard: Painted Steel Narrow Door Jamb



Option: Hairline Stainless Steel Wide Door Jamb
“Only For Normal Door,Not for fire-proof Door”



Option: Hairline Stainless Steel Large Door Jamb
“Only For Normal Door,Not for fire-proof Door”

STANDARD FUNCTION

1 Full collective selective control

In the state of automatic operation the elevator automatically responds to car and hall calls signals. Passengers on every floor can register up and down call signals to call the elevator.

2 Door open time setting

According to set time, the system can distinguish holding time for door open of hall call, car call, door protection and delay.

3 Service floor setting

The system can choose to close or activate single or multiple elevator service floors as needed.

4 Timing service

The system can flexibly set the time and floors for service.

5 Door pre-close by the door close button

During door open holding in automatic running state, passengers can press the door close button to close the door in advance, which improves the efficiency.

6 Light curtain protection

When the light curtain is blocked during door closing, the door will open again. But light curtain protection doesn't work in the state of firefighting.

7 Automatic car light and ventilation fan shut off

If no call or call registration is registered after set time, car light and fan are automatically shut off. If a call is received, light and fan are switched on again.

8 Automatic door open upon door lock abnormality

If the system detects that the door lock circuit is abnormal during door open/close, the elevator automatically opens and closes the door again, and reports a fault after the set door open/close times is reached.

9 Landing at another floor

If door open limit signal is still invalid after door open time exceeds protection time, elevator will automatically run to the nearest floor.

10 Response and landing during acceleration

For calls during the acceleration, elevator will respond to the calls and land.

11 Cancellation of wrong car calls

Passengers can press the button consecutively twice to cancel wrong car calls.

12 Attendant running

In attendant state, the running of the elevators is controlled by the attendant.

13 Self-rescue at low speed

When elevator is under normal service and doesn't stop at the leveling zone, elevator will move to the leveling zone with slow speed as long as it meets the safety requirements of starting.

14 Button stuck diagnosis

The control system can automatically identify whether a hall call button is stuck and cancel the stuck call, preventing the condition that the elevator cannot close the door.

15 Startup torque automatic compensation

The system automatically implements startup torque compensation based on the current car load, achieving smooth startup and the riding comfort.

16 Direct landing

The control system automatically calculates to generate running curve and directly land at leveling position without creeping.

17 The best curve automatic generation

The control system automatically generates speed curve which is most suitable for human-machine function principle.

18 Record of running times

Elevator can record the running times automatically.

19 Record of running time

Elevator can record the actual running time automatically.

20 Independent travel

All hall call signals are cancelled, elevators only respond to the car call signals.

21 Overload indication

When the load in car is more than related load, the elevator door will keep opening and there will be overload indication in the car.

22 Full load indication

Landing indicator shows the elevator is in the state of full load.

STANDARD FUNCTION

23 Full load bypass

In the state of full load the elevator only responds to car call signals.

24 Electronic weighing

An electronic weighing device measures car load accurately.

25 Non-leveling zone protection

If the control system detects landing door or car door has been opened while the elevator is in the non-leveling zone, the car operation will be stopped.

26 Fault data record

The control system can record the detailed fault information automatically to improve the efficiency of maintenance.

27 Simple maintenance keypad

The keypad provides the functions, such as commissioning the running floors, door opening, closing and etc.

28 Commissioning in car

The hand operation panel can be connected to the system in the car for elevator commissioning, which improves commissioning efficiency.

29 Hoistway self-learning function

The elevator runs to the highest floor from the lowest floor at inspection speed and save all of the parameters automatically in the operational process.

30 Inspection running

During inspection, the control system will cancel automatic operation of elevator and door. Pushing up (or down) button can make the elevator inch at inspection speed.

31 Motor parameters tuning

By parameters setting, the system can complete learning of the related control parameters of motor with or without load.

32 Floor position intelligent correction

When elevator arrives at terminal floor, the system will automatically check and correct car position information and completely eliminate faults for over travel top terminal or bottom terminal.

33 Fire emergency travel

Elevator will cancel registered calls, return to firefighting main floor and keep doors open after receiving fire signal.

34 Fire emergency travel indication

During fire emergency travel landing operation indicator displays fire emergency travel.

35 Fireman service operation

Under the mode of fireman service operation the elevator only can open or close the door by constantly pushing open or close buttons. At this time the elevator only responds to car calls (Only one car call can be registered every time.)

The longest traveling time shall be less than 60s (standard function)

36 Firefighting "No entry" indication

In case of fire and elevator on the firefighting floor, the "No entry" light on the fire box will be lit.

37 Firefighting feedback

When elevator receives the fire alarm signal or fireman service signal, it will return to the firefighting floor to provide relay output interface for fire-service center or BAS system.

38 Parking switch

In the state of automatic operation, if elevator parking switch is actuated, the elevator will return to main floor and stop automatic running.

39 Troubleshooting based on fault levels

Faults are classified into different levels based on the severity. Different levels of faults are rectified by using different methods to improve efficiency.

40 Overspeed stop running

If the elevator speed exceeds the limit, the elevator immediately stops running.

41 Terminal floor data correction

If the system detects the abnormal location, the elevator will travel to the terminal level for inspection in order to secure the safety and reliability of the system.

STANDARD FUNCTION

42 Passenger rescue first

Elevator classifies the fault levels automatically, and it will return to leveling position to let passengers get out under the condition of safe running.

43 Light load anti- nuisance function

The number of car calls registered at the same time is limited under light load.

44 Intercom

A five-way intercom linking car top, the car, the pit, the machine room, and the monitoring room is provided.

45 Alarm bell

When the alarm bell button is pushed, the alarm bell will ring.

46 Parameter copying

Uploading and downloading parameters to control system by hand-held operator.

47 Parameter inspection

Use this function to find out the parameters set by system which are not insistent with original parameters.

48 Special display

The system is able to set the display if non-sequenced floor display in car and hall is requested by the customer.

49 Running direction and floor display

The floor number on which the elevator is and current running direction is displayed on car operation panel and landing call box.

50 Door open with floor button

Before elevator starts, push the button on this floor, the car door will be opened automatically.

51 Reverse hall call registration

The call will be registered if the call direction of this floor is not in the travel direction.

52 Anti-slip protection

The elevator will stop running when steel wire rope slipping is detected.

53 Power failure data holding

All running data will be saved completely and correctly when the power supply is cut off.

54 Automatic main floor returning

Under automatic travel, the elevator will return to the main floor waiting if there is no car call or hall call for a period of time. The elevator will respond to any call immediately during the process of returning to the main floor.

55 Emergency car lighting

Emergency lighting in car will turn on automatically during power failure.

56 Landing display of out-of-service

Landing indicator shows the out-of-service state of elevator.

57 Door interlock short-circuit protection

Elevator would stop and send out alarm message when short circuit of door interlock is detected. The elevator will not operate until the fault is eliminated.

58 Brake monitoring function

The system automatically monitors the working condition of the brake to ensure the reliable operation of the brake.

59 Motor overheat protection

The system monitors whether the motor is overheated, the elevator will stop until the motor recovers to normal condition.

OPTIONAL FUNCTION

1 Duplex running

The duplex control aims at fulfilling two lifts' coordinated responding to the landing call through the data transmission from serial communication bus so that it can enhance the lift running efficiency.

2 Group control running

The group control means the concentrated control of the multiple elevators. The system can have a group control of maximum 8 elevators. In using the group control system, the elevator group can automatically choose the most appropriate response so as to avoid the repeated elevator stop, reduce the passengers' waiting period and increase the running efficiency, save the electric energy.

3 Distribution waiting

It is optional in duplex or group control.

4 Peak service

It is optional in duplex or group control.

5 Door safety edge protection

When the door safety edge is touched, the door will open again.

6 Integrated light curtain and door safety edge

Integrated light curtain provides dual protection of light curtain and safety edge.

7 Door nudging

When door nudging function is started, the elevator will enter door nudging state and slowly close the door with buzzing in the event the elevator cannot close door in excess of set time due to light curtain action. The function is optional when the elevator has integrated light curtain or safety edge.

8 Car arrival gong

After elevator arrives at destination landing according to passengers' requirements, there will be prompting signal from car top board. The function is included when there are functions of voice announcement or background music.

9 Arrival gong cancellation at night

Within the set time period, the arrival can be cancelled. The function is optional when there is car arrival gong.

10 Earthquake emergency travel

When the seismic sensors are actuated, all elevators will stop promptly at the nearest available floor and park there with doors open.

11 ARD(automatic rescue device)

If the elevator suddenly stops the running in the mid way due to power failure, this device will actuate rapidly to slowly drive lift to the leveling position. After the leveling, it opens the door to rescue the passengers.

12 Standby power transfer device

A standby power transfer device is provided. (Three-phase 380V automatic transfer device can be provided by us, and automatic transfer device of other voltage classes are provided by customers.)

13 Standby power transfer device interface

Standby power transfer device interface is provided.

14 Voice announcement function

Such information as running direction and arrival floors are automatically announced to passengers in the process of running.

15 Background music function

Melodious background music is provided in car when elevator is put into operation.

16 Pre-opening

When the elevator normally decelerates to the destination landing door zone, if it satisfies the function of opening the door ahead of time, it will do so.

17 Releveling

After the elevator parks at the current floor, as too much passengers enter into or leave the elevator, it results in the expansion or shrink of the steel rope, the car will be separated from the leveling zone. Under the door open conditions, the lift will start the low speed running to the leveling point.

18 Hall lantern

When the elevator arrives at destination floor, hall lantern will be lit.

19 Security floor

After the security floor function is enabled, the security floor is used at 10:00 p.m. to 6:00 a.m., and the elevator runs to the security floor first every time, stops and opens the door, and then runs to the destination floor.

20 Car camera interface reserved

Coaxial communication cable is included in traveling cable. The function is included when there is car camera device.

21 Car camera device

Cameras are installed in car to monitor situation in car.

22 Automatic lock elevator

Make elevator enter into and exit the state of lock elevator automatically by setting automatic lock elevator period in control system.

23 Auxiliary car operation panel

This panel can be conveniently used for passengers in large-capacity elevators.

24 Operation panel for the disabled

The operation panel is designed for the disabled and has such functions as door open and close, floor selection and sending out rescue signals under special circumstance.

25 Through opening door function

When there are two doors for a car, automatic control on the two doors depends on your requirements.

26 IC card

Passengers need to use the IC card to go to floors that require authorization.

PLANFORM OF HOISTWAY/MACHINE ROOM

Construction layout elevation drawing

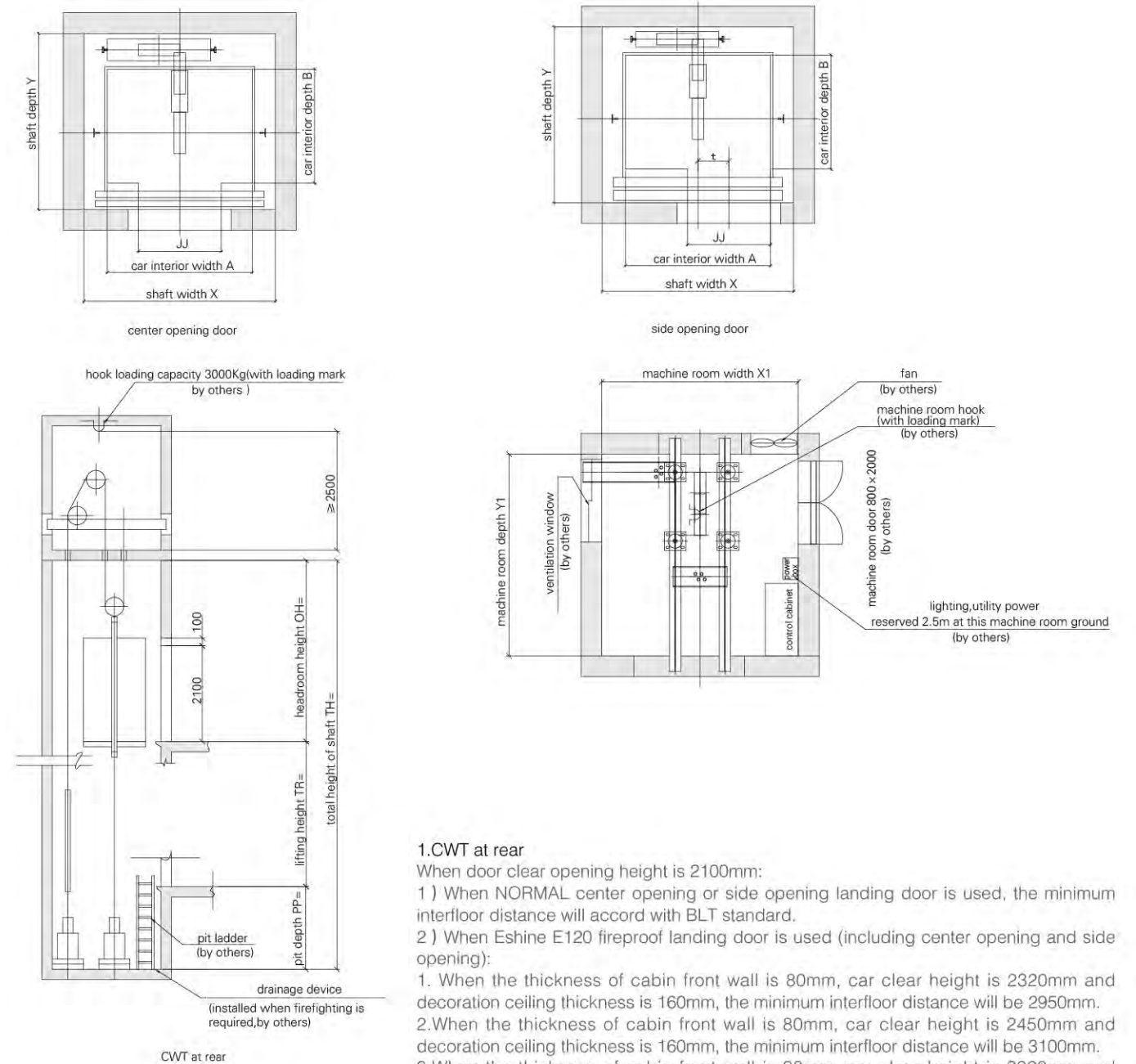

1.CWT at rear

When door clear opening height is 2100mm:

1) When NORMAL center opening or side opening landing door is used, the minimum interfloor distance will accord with BLT standard.

2) When Eshine E120 fireproof landing door is used (including center opening and side opening):

1. When the thickness of cabin front wall is 80mm, car clear height is 2320mm and decoration ceiling thickness is 160mm, the minimum interfloor distance will be 2950mm.

2. When the thickness of cabin front wall is 80mm, car clear height is 2450mm and decoration ceiling thickness is 160mm, the minimum interfloor distance will be 3100mm.

3. When the thickness of cabin front wall is 30mm, car clear height is 2320mm and decoration ceiling thickness is 160mm, the minimum interfloor distance will be 3100mm.

4. When the thickness of cabin front wall is 30mm, car clear height is 2450mm and decoration ceiling thickness is 160mm, the minimum interfloor distance will be 3250mm.

PLANFORM OF

HOISTWAY/MACHINE ROOM

Construction layout elevation drawing

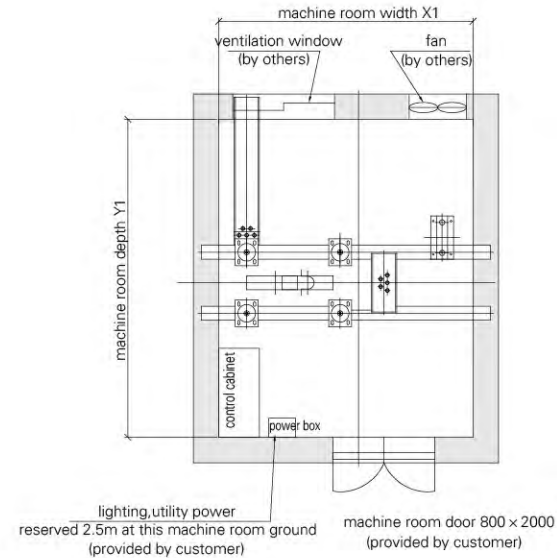
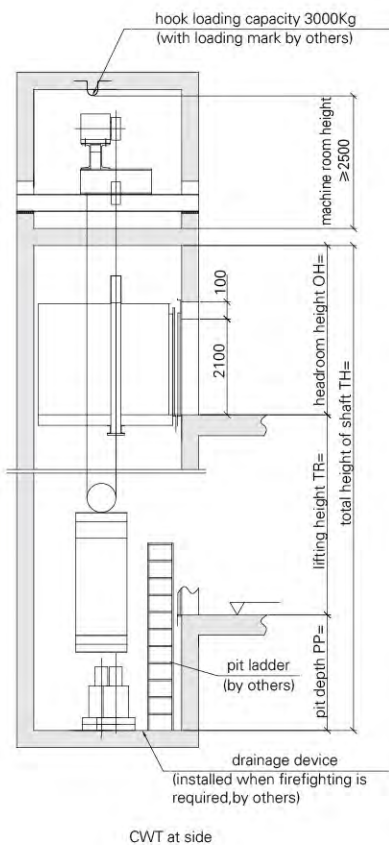
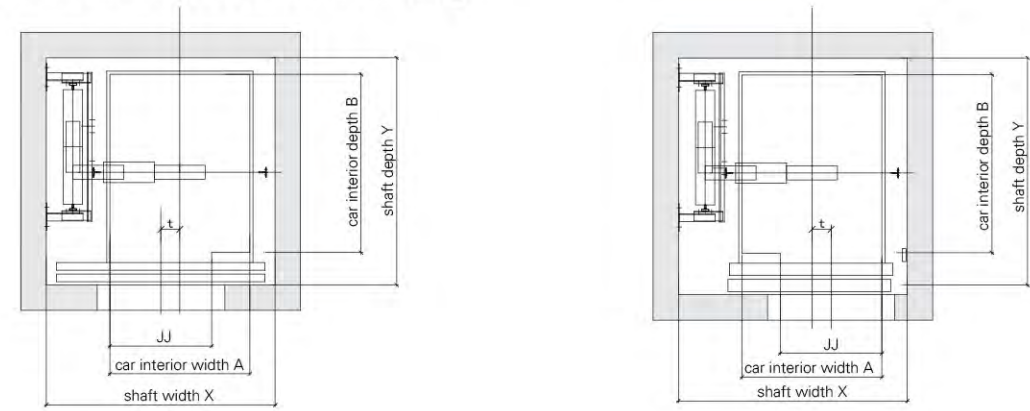

2.CWT at side

When door clear opening height is 2100mm;

1) When NORMAL center opening or side opening landing door is used, the minimum interfloor distance will accord with BLT standard.

2) When Eshine E120 fireproof landing door is used (including center opening and side opening):

1. When the thickness of car front wall is 80mm, car clear height is 2320mm and decoration ceiling thickness is 160mm, the minimum interfloor distance will be 2950mm.
2. When the thickness of car front wall is 80mm, car clear height is 2450mm and decoration ceiling thickness is 160mm, the minimum interfloor distance will be 3100mm.
3. When the thickness of car front wall is 30mm, car clear height is 2320mm and decoration ceiling thickness is 160mm, the minimum interfloor distance will be 3100mm.
4. When the thickness of car front wall is 30mm, car clear height is 2450mm and decoration ceiling thickness is 160mm, the minimum interfloor distance will be 3250mm.

PLANFORM OF

HOISTWAY/MACHINE ROOM

Rated load (kg)	Rated speed(m/s)	Car dimension (A × B × H)	Car dimension (A × B × H)	Opening dimension (JJ × DH)	Hoistway dimension(X × Y)		Machine room dimension(X1 × Y1)	
					Common door	fireproof door	Common door	fireproof door
400	1.0	1000 × 1000 × 2320	1000 × 1000 × 2450	CO 700 × 2100	1600 × 1525	1600 × 1465	1900 × 1525	1900 × 1465
	1.6			2S 700 × 2100	CWT at rear 1500 × 1600	1500 × 1540	1800 × 1600	1800 × 1540
	1.75				CWT at side 1600 × 1520	1600 × 1465	1600 × 1520	1600 × 1465
450	1.0	1000 × 1250 × 2320	1000 × 1250 × 2450	CO 700 × 2100	1600 × 1775	1600 × 1715	1900 × 1775	1900 × 1715
				2S 800 × 2100	CWT at rear 1600 × 1850	1600 × 1790	1900 × 1850	1900 × 1790
					CWT at side 1600 × 1690	1600 × 1630	1600 × 1690	1600 × 1630
	1.6	1250 × 1000 × 2320	1250 × 1000 × 2450	CO 700 × 2100	1650 × 1525	1650 × 1465	1950 × 1525	1950 × 1465
				2S 800 × 2100	1700 × 1600	1650 × 1540	2000 × 1600	1950 × 1540
					CO 800 × 2100	1850 × 1400	1850 × 1390	1850 × 1400
630	1.0-2.5	1400 × 1100 × 2320	1400 × 1100 × 2320	CO 800 × 2100	1850 × 1700	1850 × 1690	1850 × 1700	1850 × 1690
				2S 800 × 2100	1800 × 1785	1800 × 1775	1800 × 1785	1800 × 1775
					CO 800 × 2100	1800 × 1860	1800 × 1850	1800 × 1860
800	1.0-2.5	1350 × 1400 × 2320	1350 × 1400 × 2450	CO 800 × 2100	1800 × 2000	1800 × 1990	1800 × 2000	1800 × 1990
800	1.0-2.5	1400 × 1350 × 2320	1400 × 1350 × 2450	CO 800 × 2100	1850 × 1950	1850 × 1940	1850 × 1950	1850 × 1940
900	1.0-2.5	1600 × 1350 × 2320	1600 × 1350 × 2450	CO 900(1000) × 2100; 2000(2200) × 1950	2000(2200) × 1940	2000(2200) × 1940	2000(2200) × 1950	2000(2200) × 1940
1000	1.0-2.5	1500 × 1500 × 2320	1500 × 1500 × 2450	CO 900 × 2100	2000 × 2100	2000 × 2090	2000 × 2100	2000 × 2090
1000	1.0-2.5	1600 × 1400 × 2320	1600 × 1400 × 2450	CO 900(1000) × 2100; 2000(2200) × 2000	2000(2200) × 1990	2000(2200) × 1990	2000(2200) × 2000	2000(2200) × 1990
1000	1.0-2.5	1600 × 1500 × 2320	1600 × 1500 × 2450	CO 900(1000) × 2100; 2000(2200) × 2100	2000(2200) × 2090	2000(2200) × 2090	2000(2200) × 2100	2000(2200) × 2090
1000	1.0-2.5	1100 × 2100 × 2320	1100 × 2100 × 2450	CO 900 × 2100	2000 × 2500	2000 × 2490	2000 × 2500	2000 × 2490
1150	1.0-2.5	1800 × 1450 × 2320	1800 × 1450 × 2450	CO 1000 × 2100	2300 × 2050	2300 × 2040	2300 × 2050	2300 × 2040

Additional safety gear at CWT side

Rated load (kg)	Rated speed(m/s)	Car dimension (A × B × H)	Car dimension (A × B × H)	Opening dimension (JJ × DH)	Hoistway dimension (X × Y)	Machine room dimension (X1 × Y1)
800	1.0-2.5	1350 × 1400 × 2320	1350 × 1400 × 2450	CO 800 × 2100	1800 × 2100	1800 × 2100

Rated speed(m/s)	When car clear height is 2320, top terminal landing height(mm) safety gear at CWT side/ no safety gear at CWT side	When car clear height is 2450, top terminal landing height(mm) (including the condition with safety gear at CWT side)	Pit depth(mm)
1.0	3950	4050	1200
1.6	4100	4200	1300
1.75	4150	4250	1350
2.0	4250	4400	1550
2.5	4500/4530	4630	1600